



17 Heaton Drive, Birmingham, B15 3LW

**£850,000**

Hadleigh Estate Agents are delighted to offer this substantial property for sale. Located on the ever popular Heaton Drive, the property boasts a substantial plot size and rear garden.

The property boasts a large 'In and Out' driveway and double garage with electric door. Internally the property benefits from three reception rooms, a spacious kitchen, guest WC and utility area. The first floor accommodation comprises three spacious bedrooms, with the master having its own dressing room and ensuite. Completing upstairs is an additional bathroom and WC. To the rear of the property is a significant private garden and patio area.

## Location



Heaton Drive is a prime location situated within a private cul-de-sac, being highly regarded for its established community of long-standing residents. Families will appreciate the proximity to highly regarded schools, including a wide range of excellent private and state run schools. The property is just a short distance from the expansive Cannon Hill Park and the picturesque Edgbaston Reservoir, providing ample opportunities for outdoor activities. Edgbaston itself is well-known for its attractive tree-lined streets, impressive architecture, and a mix of local shops, restaurants, and cafes. The property is within easy reach of the bustling Harborne High Street, which offers a variety of independent retailers, pubs, and eateries. For commuters, excellent transport links are available, with easy access to the City Centre. Edgbaston is also home to a number of cultural and recreational amenities, including the famous Edgbaston Priory Club, renowned for its tennis facilities, and the nearby Birmingham Botanical Gardens, offering a peaceful retreat in the heart of the city.

## Entrance Porch

Glazed double doors and window to front elevation, ceiling light point and internal letterbox.

## Hallway



Spacious and welcoming hallway, enclosing internal storage cupboard. Ceiling light point, central heating radiator, coving and stairs to first floor accommodation.

## Lounge



Dual aspect glazed windows and patio doors leading to rear garden. Ceiling spotlights, central heating radiator and feature fireplace. Sliding doors lead to the dining room.

## Dining Room



Dual aspect glazed windows to side and rear elevation, ceiling light point, central heating radiator and electric heater.

## Kitchen



Spacious fitted kitchen with a range of base and wall units. Glazed window to front elevation and sliding patio doors leading to the garden.

## Reception Room



An additional multi purpose reception room, offering window to front elevation and rear patio doors. Ceiling spotlights and central heating radiator.

## Guest WC



Low level flush WC, hand wash basin and ceiling light point.

## Storage Room



Spacious storage room allowing for plumbing for utilities. Additional storage cupboards along with further guest WC.

## Garage



Large double garage with up and over electric door.

## Landing



Spacious landing benefitting from windows to front elevation and open bannister. Ceiling light points, central heating radiator and loft access.

## Master Bedroom



Large master suite, offering two windows to rear elevation, ceiling spotlights, in built wardrobe and central heating radiator. Further providing access to dressing room.

## Wardrobe



Master dressing room, offering built in wardrobes, ceiling spotlights, radiator and access to en-suite.

## Bathroom



Low level flush WC, bidet, hand wash basin and walk in shower cubicle. Radiator, ceiling spotlights and window to rear elevation.

## Bedroom Two



Spacious bedroom offering fitted wardrobes and dual aspect windows. Ceiling light point and central heating radiator.

## Bedroom Three



Dual aspect windows, hand wash basin, ceiling light point and central heating radiator.

## Bathroom



Tiled bathroom with jacuzzi bath and electric shower over. Vanity unit, window to front elevation and ceiling light point.

## WC



Partially tiled WC with low level flush WC, ceiling light point and window to front elevation.

## Garden



Substantial and private rear garden, boasting spacious paved patio area and being predominantly laid to lawn. A range of mature shrubs and trees.

## General Information

We have been advised that the property is Freehold. It is understood that a portion of the garden is held on a lease of 84 years from 29 September 1970. Hadleigh Estate Agents advise any willing client to obtain legal advice and cannot be held accountable.

Floor Plan

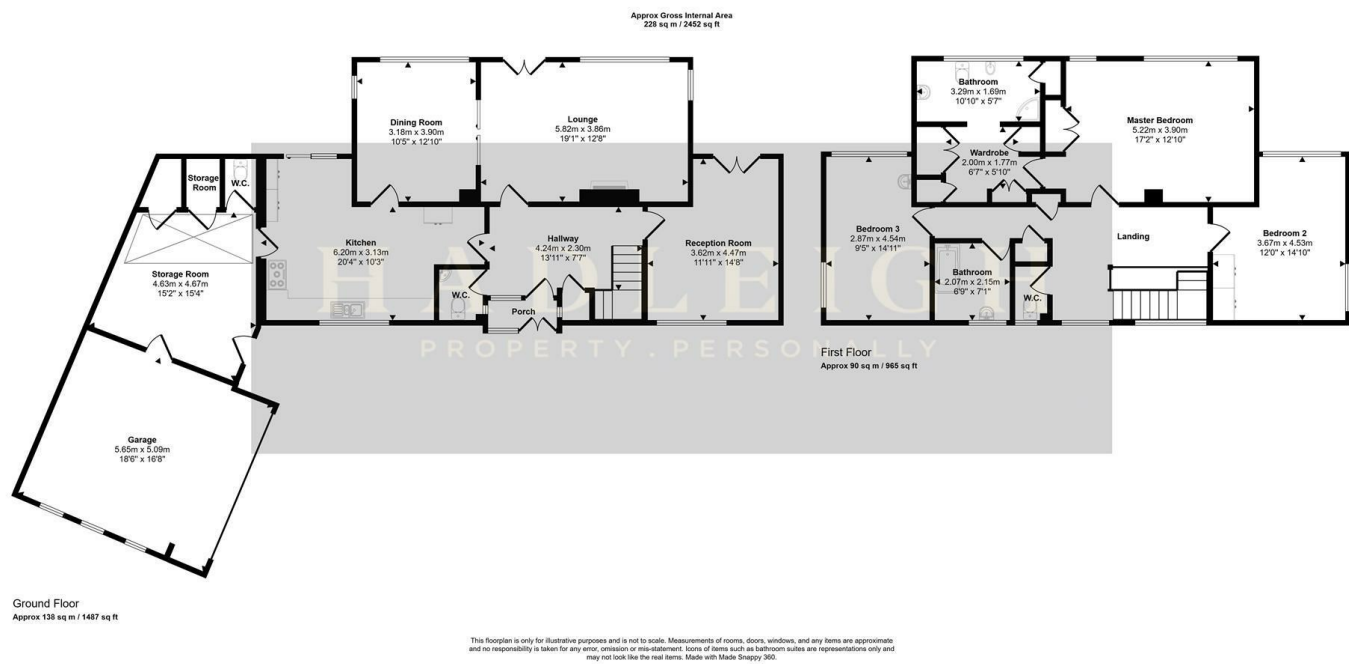

Area Map

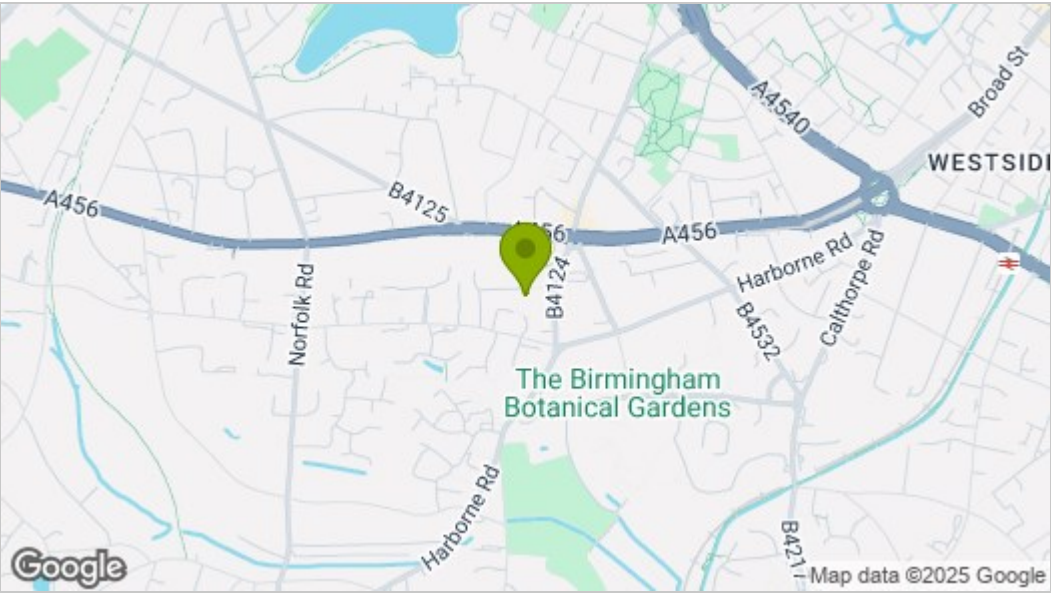

Energy Efficiency Graph

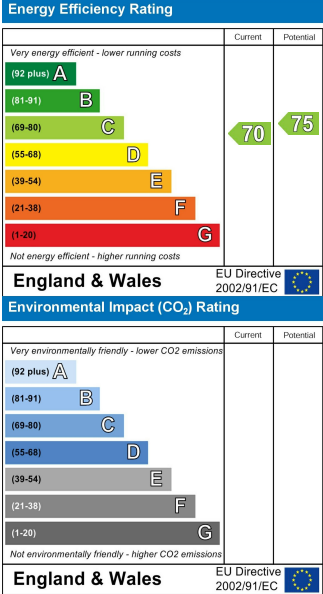

These particulars, whilst believed to be accurate are set out as a general outline only for guidance and do not constitute any part of an offer or contract. Intending purchasers should not rely on them as statements of representation of fact, but must satisfy themselves by inspection or otherwise as to their accuracy. No person in this firms employment has the authority to make or give any representation or warranty in respect of the property.